

DIGITAL APPLICATION SHEET 6800-395



| | |
|----------------------|-------------------------|
| VEHICLE MANUFACTURER | FORD |
| MODEL | RANGER (WITH RADIO KIT) |
| YEAR OF MANUFACTURE | 2006-2009 |
| ENGINE TYPE | DURATORQ |
| TRANSMISSION | AUTOMATIC |
| VOLTAGE | 12V |



STONERIDGE DIGITAL KIT FOR THIS VEHICLE: 7800-116

| PARTS LIST | QUANTITY | STONERIDGE PART NO. |
|-----------------------|----------|---------------------|
| M1N1 DIGITAL KIT | 1 | 9800-004 |
| CD / TACHOGRAPH FACIA | 1 | 6800-089 |
| CD / RADIO PLAYER | 1 | 6800-090 |
| ISO HARNESS | 1 | 6800-088 |
| DRIVER QUICKGUIDE | 1 | 102022P/01 |
| APPLICATION SHEET | 1 | 6800-395 |

Ensure that 2nd Source of motion is set to C3 Enabled and C3 Speed Factor is set correctly within Sensor Test within MKIII Programmer on the Optimo.

ADDITIONAL VEHICLE MANUFACTURERS PARTS REQUIRED

NONE

Workshop Technical Support

Tel +44 (0) 1382 866 400 (choose opt.2. opt.1)

Fax +44 (0) 1382 866 401

Email workshop.support@stoneridge.com

Sales Office

Tel +44 (0) 1382 866 400 (choose opt.1)

Fax +44 (0) 1382 866 401

Email sales@stoneridge.com

Page 1



Whilst we have endeavoured to ensure the accuracy of the information supplied, Stoneridge Electronics cannot be held responsible for any errors or omissions. It is the installer's responsibility to ensure compliance with specific vehicle manufacturers repair procedures, especially with regard to the procedure for disconnection/reconnection of the battery. Failure to comply with the vehicle manufacturers instructions may result in personal injury and/or component damage/data

FITTING INFORMATION



1. Unclip the cover around the cluster.



2. The M1N1 is installed behind the cluster



3. The Adaptor must be sealed to a non Removable part of the vehicle. Use the Cross frame bar to loop the sealing wire around.



4. Remove original CD facia by removing the 3 knobs, then removing the 2 screws.

Workshop Technical Support

Tel +44 (0) 1382 866 400 (choose opt.2. opt.1)

Fax +44 (0) 1382 866 401

Email workshop.support@stoneridge.com

Sales Office

Tel +44 (0) 1382 866 400 (choose opt.1)

Fax +44 (0) 1382 866 401

Email sales@stoneridge.com

5. The Facia can then be clicked out of the surrounding panelling by prising it off.
6. Remove the 2 screws which hold in the hazard warning button and also the 3 screws which hold in the Air Conditioning buttons.
7. Unclip the white CD connector and slide out the aerial connection

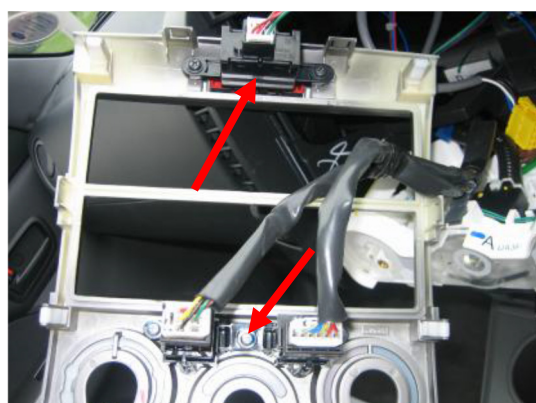

8. Fit the Hazard Warning and Air Conditioning buttons into the new CD / Tachograph facia



9. Install the tachograph cage before clipping on the new facia and ensure the 2 screws are secure before replacing the knobs.

Workshop Technical Support

Tel +44 (0) 1382 866 400 (choose opt.2. opt.1)

Fax +44 (0) 1382 866 401

Email workshop.support@stoneridge.com

Sales Office

Tel +44 (0) 1382 866 400 (choose opt.1)

Fax +44 (0) 1382 866 401

Email sales@stoneridge.com

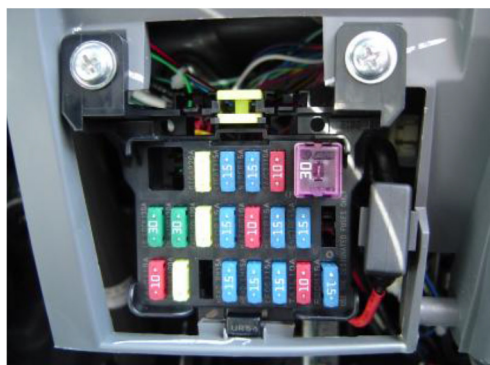

10. Locate the fuse box to the bottom right hand side of the steering wheel.

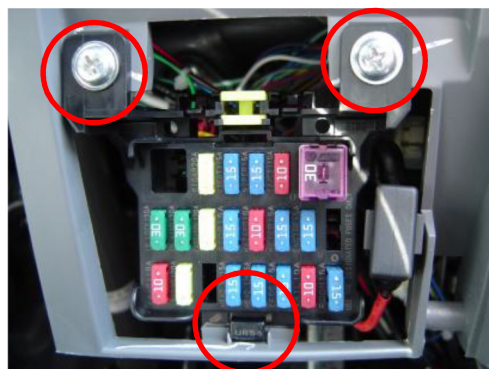

11. Remove the fuse box by unscrewing the 2 screws and unclipping the clasp at The bottom.

12. Use the wires from the following fuses to power the tachograph:-

Wire from rear of fuse marked 1 goes to connector A1 of tachograph through a 1 amp fuse, marked 4.

Wire from rear of fuse marked 2 goes to connector A2 of tachograph.

Wire from rear of fuse marked 3 goes to Connector A3 of tachograph

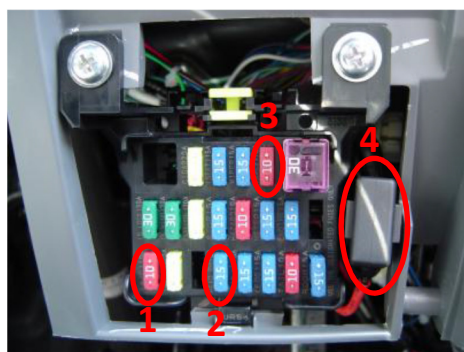

Workshop Technical Support

Tel +44 (0) 1382 866 400 (choose opt.2. opt.1)

Fax +44 (0) 1382 866 401

Email workshop.support@stoneridge.com

Sales Office

Tel +44 (0) 1382 866 400 (choose opt.1)

Fax +44 (0) 1382 866 401

Email sales@stoneridge.com

Page 4



13. The Ground connections for A5 and A6 of the tachograph can be picked up from the common ground bolt near the accelerator.



14. Attach the Yellow wire from the M1N1 to the Blue wire with Silver flashes behind cluster as shown.

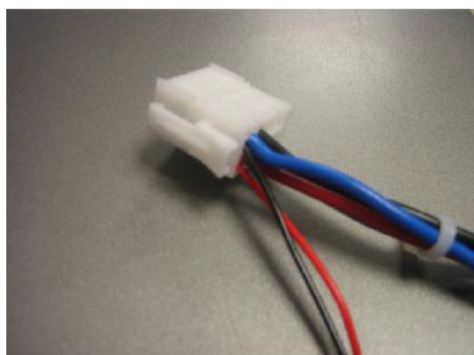

15. Connect Black wire from the M1N1 into Plug A Pin 5 and connect the Red wire from the M1N1 into Plug A Pin 1 of the tachograph as shown.



16. The sender cable and A connector are fed behind cluster to the new facia.

17. The tachograph can now be connected and installed.

18. The CD / Radio can now be connected and installed using the ISO Harness.



Workshop Technical Support

Tel +44 (0) 1382 866 400 (choose opt.2. opt.1)

Fax +44 (0) 1382 866 401

Email workshop.support@stoneridge.com

Sales Office

Tel +44 (0) 1382 866 400 (choose opt.1)

Fax +44 (0) 1382 866 401

Email sales@stoneridge.com



19. The Tachograph is now ready for calibration



20. Seal the sender and connector
Through the Red Seal provided to the Adaptor.



21. The 2nd Source of motion is obtained
By using the GPS Module and cable
Harness as shown.



22. The cable harness is connected directly
Inline with the tachograph power cable
When connecting to the tachograph as
shown.

23. The GPS Module should be placed in a
suitable area within the cab, preferably
in an area next to the windscreen.

Workshop Technical Support

Tel +44 (0) 1382 866 400 (choose opt.2. opt.1)

Fax +44 (0) 1382 866 401

Email workshop.support@stoneridge.com

Sales Office

Tel +44 (0) 1382 866 400 (choose opt.1)

Fax +44 (0) 1382 866 401

Email sales@stoneridge.com



PROGRAMMING PARAMETERS FOR FITTING THIS VEHICLE WITH AN SE5000 KRM SERIES TACHOGRAPH

Note. Read the parameters of the tachograph to be replaced, and note all connections to the tachograph, paying particular attention to Vpulse, dual axle configuration, D8 serial data, Revs input etc.

The below vehicle settings are the default vehicle settings which should be applied. However, individual vehicle specifications may vary.

Default setting for D6 outputs that can be switched between ISO & Open collector (o/c) is ISO.

The vehicle must be calibrated in an approved manner after fitting.

The road speed limiter must be calibrated after a replacement tachograph is fitted.

The illumination of the KRM series tachograph can be changed between White & Green, please select the colour best suited to the vehicle illumination.

If you are in doubt regarding the replacement of any tachograph with a KRM series product please call: Workshop Support on 0870 887 9200 option2, option1. or email workshop.support@stoneridge.com

Workshop Technical Support

Tel +44 (0) 1382 866 400 (choose opt.2. opt.1)

Fax +44 (0) 1382 866 401

Email workshop.support@stoneridge.com

Sales Office

Tel +44 (0) 1382 866 400 (choose opt.1)

Fax +44 (0) 1382 866 401

Email sales@stoneridge.com



| TACHOGRAPH | CANBUS | CAN TYPE | CAN TERMINATION | ILLUMINATION | REVS INPUT | SPEED LIMITER SETTING | D6 |
|------------|--------|----------|-----------------|--------------|------------|-----------------------|-----|
| 5002KRM | OFF | N/A | N/A | A2 | C3 | 90km/H | ISO |

| READ ALL DATA LOG | | | |
|--------------------|---|----------------------|---------------|
| PARAMETER | VALUE/SETTING | PARAMETER | VALUE/SETTING |
| W-FACTOR | | Def. KEY ON/OFF | |
| K-FACTOR | | RPM FACTOR | |
| L-FACTOR | | D4 PIN FUNCTION | |
| TYRE SIZE | | D5 PIN FUNCTION | |
| VIN | | D6 PIN FUNCTION | |
| VRN | | D7 PIN FUNCTION | |
| VEH. REG. NATION | | SERIAL DATA OUT (D8) | |
| PREF. LANGUAGE | | C1 PIN FUNCTION | |
| CURRENT TIME | | FILTER PIN B3 | |
| CURRENT DATE | | CAN TRIP RESET | |
| INSTALL DATE | | CAN WAKE UP | |
| ACTIVATION TIME | READ ONLY. -DATE FORMAT / UNACTIVATED | RD CAN CONFIG | |
| SERVICE DELAY | | ADD. EVENT REC. | |
| ODOMETER | | ENG. SPEED REC. | |
| O/P SHAFT FACTOR | | VRES D | |
| SPEED O/P FACTOR | | VEH. SPEED REC. | |
| RESET HEARTBEAT | | VRVSD | |
| LOW SPEED LIMIT | | PRE-OVERSPEED | |
| BACKLIGHT SELECT | | PRE-NEXT CALIBRATION | |
| ILLUMINATION LEVEL | | WARRANTY TIME | |
| ILLUMINATION OFF | | LOW POWER BAND | |

Workshop Technical Support

Tel +44 (0) 1382 866 400 (choose opt.2. opt.1)

Fax +44 (0) 1382 866 401

Email workshop.support@stoneridge.com

Sales Office

Tel +44 (0) 1382 866 400 (choose opt.1)

Fax +44 (0) 1382 866 401

Email sales@stoneridge.com